

THIS DRAWING IS UNPUBLISHED. RELEASED FOR PUBLICATION  
 © COPYRIGHT BY TYCO ELECTRONICS CORPORATION. ALL RIGHTS RESERVED.

LOC	DIST	REVISIONS			
P	LTR	DESCRIPTION	DATE	DWN	APVD
AJ	16	G	REV PER 0514-0252-04	12-02-04	JDP GM

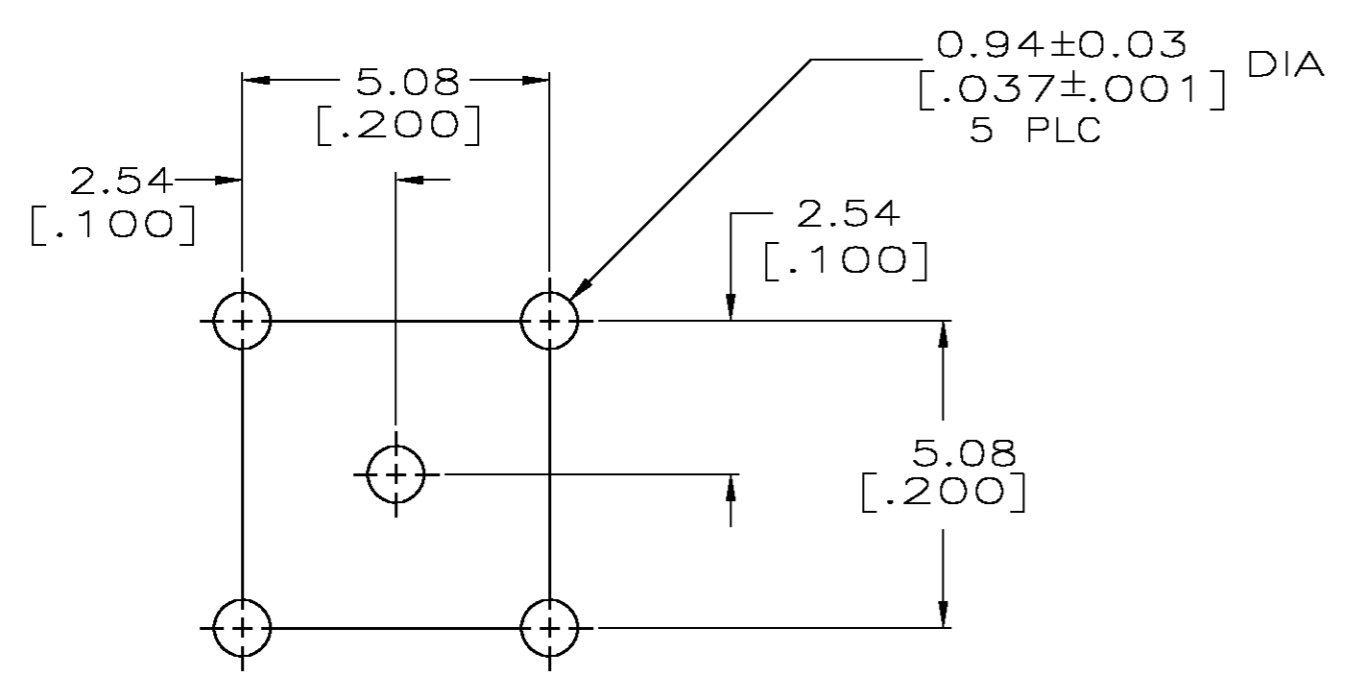
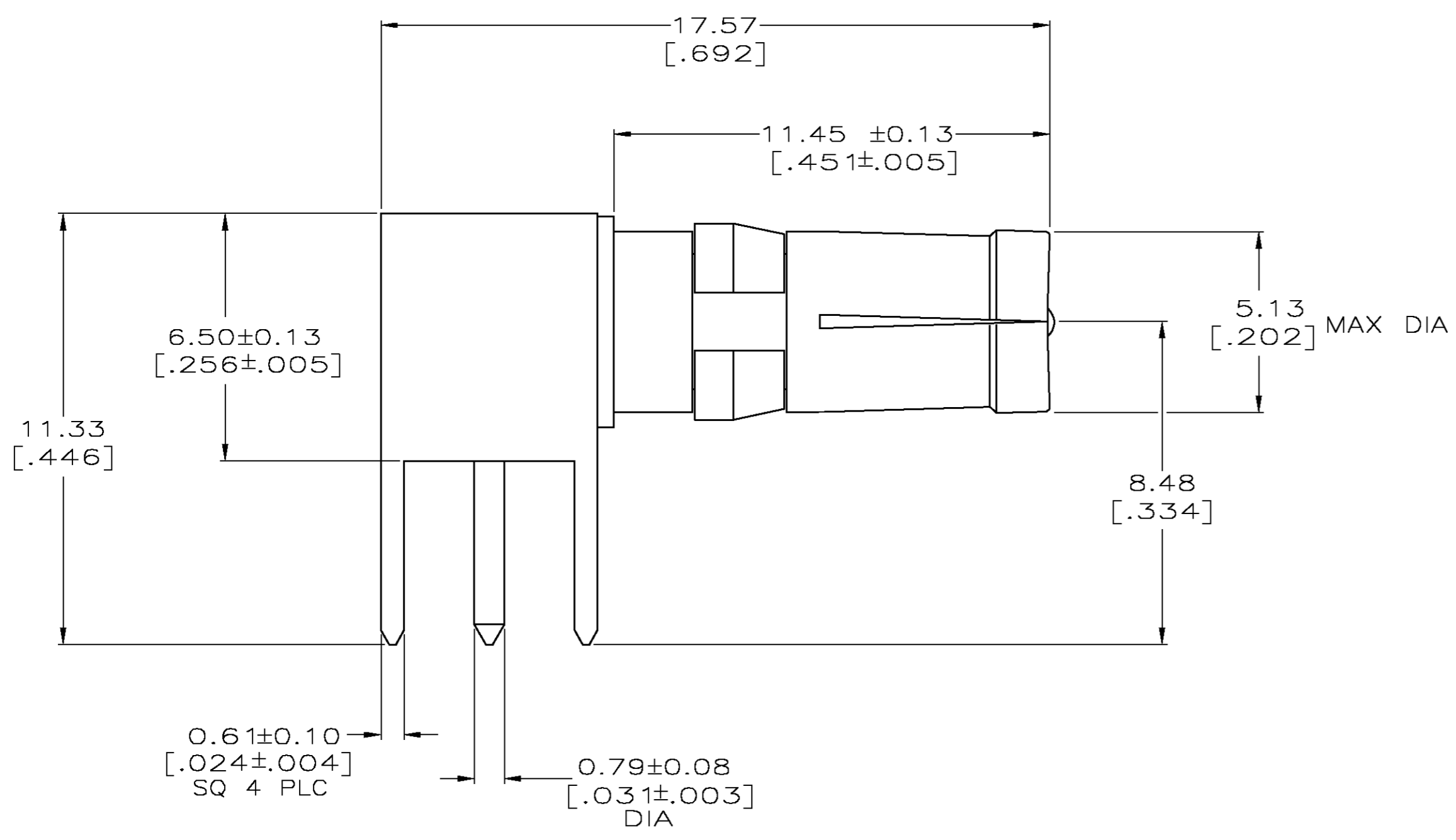

PCB CONFIGURATION

- 1. BRASS PER QQ-B-626.
- 2. PTFE PER MIL-P-19468.
- 3. PHOSPHOR BRONZE PER QQ-B-750.
- 4. BERYLLIUM COPPER PER QQ-C-530.
- 5. TIN PLATE PER ASTM-B-545.
- 6. COPPER PLATE PER MIL-C-14550.
- 7. NICKEL PLATE PER QQ-N-290.
- 8. GOLD PLATE PER MIL-G-45204.
- 9. DIELECTRIC AND CONTACT ASSEMBLY WILL WITHSTAND 2.5 LB PUSHOUT FORCE DIRECTED FROM MATING END.

OBSELETE	221162-2
	221162-1
PART NUMBER	

THIS DRAWING IS A CONTROLLED DOCUMENT.		DWN H. B. JOHNSON 08-20-91	Tyco Electronics Corporation Harrisburg, Pa 17105-3608	
DIMENSIONS: INCHES		CHK B. WERNER 08-29-91		
TOLERANCES UNLESS OTHERWISE SPECIFIED:		APVD D. DOYE 09-5-91	NAME SOCKET,PCB,RIGHT ANGLE SIZE 8, HDI	
0 PLC ± - 1 PLC ± - 2 PLC ± - 3 PLC ± .010 4 PLC ± - ANGLES ± 0° 30'		PRODUCT SPEC -	SIZE A2	CAGE CODE 00779
MATERIAL -		FINISH -	DRAWING NO C=221162	RESTRICTED TO -
CUSTOMER DRAWING		WEIGHT -	SCALE 1:1	SHEET 1 OF 1
			REV G	

221162